



American Made Lasers & Mounting Hardware Since 1985



Catalog

Email: sales@lumberlinelaser.com Web: www.lumberlinelaser.com

Call us Toll Free: 855-686-3077 Fax: 360-686-3033

LASERS

We offer **several** power levels in **two** power input configurations, allowing simple connections from line level AC input to low voltage AC/DC, making it easier than ever to find a unit for use with your systems.



General:

- Manufactured in the USA
- Solid State Laser
- 24 month warranty
- Repairable

Dimensions:

Length: 2.75-4in

Diameter: 1.25in

Power Level Chart

Power Levels Line Lengths	
05mW	0-6 ft (0-2 meters)
10mW	0-15ft (0-5 meters)
15mW	0-18ft (0-6 meters)
30mW	0-24 ft (0-7.5 meters)
50mW	30+ ft (10+ meters)

Red available in: 05,10,15 & 30mW *All lengths given assuming average ambient light.
Green available in: 05,10,30 & 50mW

To order:

Replace the X's in the model number following the series prefix with the power level and configuration that you require.

E.g., **L-05-R** would represent a 05mW laser with the built in power supply configuration.

For **GREEN** add "-GRN"

For the **R M12** variant add

"M12" (E.g., **L-05-R-GRN M12**)

X	-	XX	-	X
Series Prefix		Power Level		Configuration

*We only offer the 15mW laser in **RED** and our 50mW laser in **GREEN**.



L-XX-LV

The L-XX-LV features a built-in low voltage power converter, accepting a wide range of power inputs for machine voltage or portable applications. *Specify cord length with your order (PT# CBL-2,5,10)

Power Inputs: 4.5-36 VDC

9-25 VAC

Cord Length: 2, 5 & 10 Meters

Weight: 2.3 oz

Environment: NEMA 6 / IP67



L-XX-R

The R Series has been our mainline laser. This unit features a remote power supply. It features a switch mode power supply that can run on 120-240 vac main lines. For hardwired applications, the R Series lasers can be fitted with an industry standard M12 connector for use in 5vdc control cabinet installations.

Power Supply: (PT# SA-115)

100-240 vac

50-60 hz

300ma

Cord Length: 9ft-10"

Weight: 2.3 oz



EDGERS

Our shifting assemblies for board edgers set the industry stand-ard for durability, and ease of use.

- The assemblies come with all of the routing pulleys, and cable that you will typically need to install them.
- The anodized aluminum trolleys slide on a rust resistant chrome or nitro-steel shaft, using replaceable Delrin bearings.
- Units come standard with 48" shafts, but can be ordered in lengths up to 72"

*To add a stationary saw, order an **SA-009** stationary bracket.



SA-009

SA-001

UNISON STYLE



SA-002

INDEPENDENT STYLE



GANG RIP SAWS

Below are the components of our gang rip saw racks (**SA-003**).
Simply order the three rail assembly, and purchase a trolley for each laser line that you need.

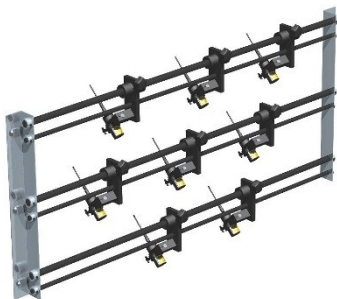

- Spacing down to less than 3/4" utilizing all three shafts
- User Replaceable bearings
- Easy thumb screw adjustment
- Order only what you need, and add on later!

COMPONENTS:

SA-011

Handset Trolley

- Delrin Bearings with snap rings for easy replacement
- Easy, accurate, adjustment
- Repeatable accuracy



SA-003

3 rail shaft set with end brackets

- Standard length is 48", but can be ordered up to 72"
- Rust resistant chrome or nitro-steel shafting

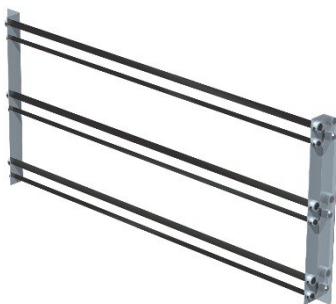

STATIONARY BRACKETS

SA-008

Use for any mounting application that is fixed.

Mounting options:

- 2ea 1/4" bolts at 3-1/4" spacing
- 1ea 5/16" bolt (omitting the formed base)

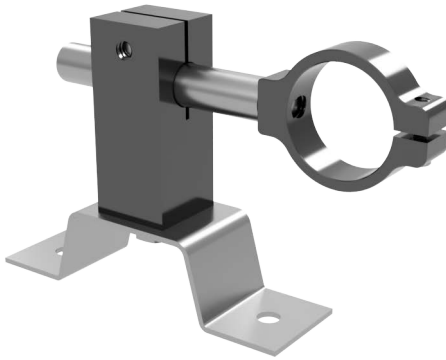

SA-009

Useful in applications that require multiple fixed lasers at a single location such as bull edgers

- Designed to clamp to a 3/4" shaft
- Use as a stationary saw bracket on our shift assemblies



ADAPTERS

SA-300

50mm laser bracket adapter is used when mounting into a preexisting machine bracket that has a 50mm ID bore. It is a compression, split style bushing and will work with any of our laser units.



SA-110 & SA-111

The **SA-110** bracket is used when mounting onto a 20mm shaft common on bridge saws and many foreign machines. The **SA-111** bracket fits onto 1/4" shaft.



SA-072

This bracket is a flexible universal base for straight line rip saws. It elevates the laser unit up off of the machine, allowing the laser to be adjusted for line length and keeps it more out of harms way.

- Height 18"
- Mounting: 2- 5/16" holes spaced 3" apart



*shown with SA-008 stationary bracket, NOT INCLUDED